

First Class Elco Gear Motor

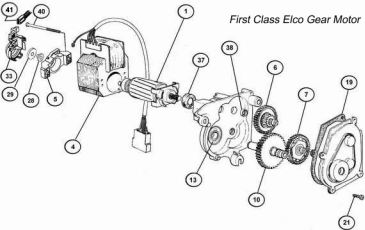

Elco Gear Motor First Class

PART#	DESCRIPTION	FC1	FC2	FC3	MFG #	RETAIL
1	ROTOR SHAFT WITH BEARINGS ***FOR ELCO GEAR MOTOR ONLY***	*	*	*	R30282535	40.84
4	STATOR ***FOR ELCO GEAR MOTOR ONLY***	*	*	*	S3295634	63.52
5	STATOR BRACKET ***FOR ELCO GEAR MOTOR ONLY***	*	*	*	C10882540	3.92
6	GEAR WITH BEARINGS ***FOR ELCO GEAR MOTOR ONLY***	*	*	*	R3392039	24.00
7	GEAR WITH BEARINGS ***FOR ELCO GEAR MOTOR ONLY***	*	*	*	R3392040	24.00
10	GEAR WITH OUTPUT SHAFT, O RINGS AND SNAP RING ***FOR ELCO GEAR MOTOR ONLY***	*	*	*	A3392041	35.20
13	OUTPUT SHAFT BEARING ***FOR ELCO GEAR MOTOR ONLY***	*	*	*	C1067130	2.24
19	GEAR BOX GASKET ***FOR ELCO GEAR MOTOR ONLY***	*	*	*	G1266019	1.60
21	GEAR BOX SCREW ***FOR ELCO GEAR MOTOR ONLY***	*	*	*	V1069200	1.92
28	MAGNET SLEEVE ***FOR ELCO GEAR MOTOR ONLY***	*	*	*	B1071202	18.24
29	PERMANENT MAGNET ***FOR ELCO GEAR MOTOR ONLY***	*	*	*	M1551004	2.24
33	COMPLETE PLASTIC COVER WITH HALL CELL ***FOR ELCO GEAR MOTOR ONLY***	*	*	*	C3072031	16.88
37	COVER VIBRATION-DAMPING ***FOR ELCO GEAR MOTOR ONLY***	*	*	*	G1071129	1.40
38	COVER VIBRATION-DAMPING ***FOR ELCO GEAR MOTOR ONLY***	*	*	*	G1071130	0.80
40	STATOR SCREW ***FOR ELCO GEAR MOTOR ONLY***	*	*	*	V10023022	0.80